

Pioneer

VREC-Z710DH

DASH CAMERA

English

Owner's Manual

Contents

Thank you for buying this Pioneer product. Please read through these instructions so you will know how to operate your model properly. After you have finished reading the instructions, keep this document in a safe place for future reference. Always read and follow the "Safety Precautions" described in this manual when installing this product in a vehicle. There is a risk of accident and injury if this product is installed using methods other than those described in this manual, or if parts are used other than those described in this manual. Pioneer Corporation accepts no responsibility whatsoever in these cases.

Precaution	4
Information to User	5
After-sales service for Pioneer products.....	7
The Safety of Your Ears is in Your Hands.....	7
Safety Precautions	8
Disclaimer	10
How to read this Manual	11
Usage Precautions	12
Check the Accessories	14
Before Installing the Product.....	15
Installation Precautions	15
Installation Tips	16
Installation	17
Specified Installation Position on Front Windshield.....	17
Recommended Installation Position on Rear Windshield	18
Connecting the Power Cable	22
Part Names.....	24
Inserting and Ejecting the microSD Card	25
Inserting the microSD Card.....	25
Ejecting the microSD Card	25
Backing Up Recorded Files	26
Folder and File Structure.....	26
Using this product	27
Power Operation.....	27
System Indicator Display.....	27
Function Buttons.....	28
Status Display.....	29
Video Recording	29
Event Recording	30
Parking Mode.....	32

SD Card Life Detection Function	33
SD Card Format Warning Function	34
Photography Feature	34
Playing Recorded Files	34
Product Settings	36
Configurable Features	38
Correcting the Errors in the Shooting Range for Detection of an Approaching Vehicle Behind	40
Guide to Recording Time and No. of Photos	42
Dedicated App	43
Trademarks & Copyrights	44
GPS	45
Troubleshooting	46
Specifications	47

Precaution

Certain country, state and provincial laws may prohibit or restrict the placement and use of this product in your vehicle. Please comply with all applicable laws and regulations regarding the use, installation and operation of this product.

WARNING

- Do not allow the battery to be exposed to fire or excessive heat or to become crushed or cut, or dispose of the battery in a fire or hot oven, which could result in an explosion.
- Do not expose a battery to high or low extreme temperatures during use, storage or transportation.

CAUTION

- The graphical symbol  placed on the product means direct current.
- When disposing of used batteries, please comply with governmental regulations or environmental public institution's rules that apply in your country / area.
- Your location may require you to post a notice to passengers that conversations are being recorded if you use the product's audio recording function. It is your responsibility to learn and comply with the requirements of your location, including notice and consent for recording audio and/or video.

If you wish to use the audio recording function, you can visit <https://pioneerelectronics.com/PUSA/arn> to print out a notice to post in your vehicle, or you can find a notice you prefer at retail. **Your use of this product, including how you provide notice to passengers, is your responsibility as the operator of the product.**

Information to User

Alteration or modifications carried out without appropriate authorization may invalidate the user's right to operate the equipment.

This device complies with part 15 of the FCC Rules. Operation is subject to the following two conditions: (1) This device may not cause harmful interference, and (2) this device must accept any interference received, including interference that may cause undesired operation.

Note

This equipment has been tested and found to comply with the limits for a Class B digital device, pursuant to Part 15 of the FCC Rules. These limits are designed to provide reasonable protection against harmful interference in a residential installation. This equipment generates, uses and can radiate radio frequency energy and, if not installed and used in accordance with the instructions, may cause harmful interference to radio communications. However, there is no guarantee that interference will not occur in a particular installation. If this equipment does cause harmful interference to radio or television reception, which can be determined by turning the equipment off and on, the user is encouraged to try to correct the interference by one or more of the following measures:

- Reorient or relocate the receiving antenna.
- Increase the separation between the equipment and receiver.
- Connect the equipment into an outlet on a circuit different from that to which the receiver is connected.
- Consult the dealer or an experienced radio/TV technician for help.

FEDERAL COMMUNICATIONS COMMISSION SUPPLIER'S DECLARATION OF CONFORMITY

Product Name: DASH CAMERA

Model Number: VREC-Z710DH

Responsible Party Name: PIONEER ELECTRONICS (USA) INC.
SERVICE SUPPORT DIVISION

Address: 2050 W. 190TH STREET, SUITE 100, TORRANCE, CA 90504, U.S.A.

Phone: 1-800-421-1404

URL: <https://www.pioneerelectronics.com>

This transmitter must not be co-located or operated in conjunction with any other antenna or transmitter.

This equipment complies with FCC/ISED radiation exposure limits set forth for an uncontrolled environment and meets the FCC radio frequency (RF) Exposure Guidelines and RSS-102 of the ISED radio frequency (RF) Exposure rules. This equipment should be installed and operated keeping the radiator at least 20 cm or more away from person's body.

This device contains licence-exempt transmitter(s)/receiver(s) that complies with Part 15 of FCC Rules and Innovation, Science, and Economic Development Canada licence-exempt RSS(s). Operation is subject to the following two conditions: (1) this device may not cause interference, and (2) this device must accept any interference, including interference that may cause undesired operation of this device.

CAN ICES-3 B/NMB-3 B

After-sales service for Pioneer products

Please contact the authorized Pioneer dealer from which you purchased this unit or an authorized Pioneer service company for aftersales service or questions you may have about the product. You may contact Pioneer directly as follows:

Do not ship your unit in for repair without contacting Pioneer first. Units sent without a return authorization number will be refused.

USA & CANADA

Pioneer Electronics (USA) Inc.
CUSTOMER SUPPORT DIVISION
P.O. Box 1760
Long Beach, CA 90801-1760 U.S.A.
800-421-1404

For warranty information, please see the Limited Warranty sheet included with this unit.

Visit our website

U.S.:

<https://www.pioneerelectronics.com>

Canada:

<https://www.pioneerelectronics.ca>

- Learn about product updates (such as firmware updates) for your product.
- Register your product.
- Access owner's manuals, spare parts information, service information, and much more.

The Safety of Your Ears is in Your Hands

Get the most out of your equipment by playing it at a safe level—a level that lets the sound come through clearly without annoying blaring or distortion and, most importantly, without affecting your sensitive hearing. Sound can be deceiving. Over time, your hearing "comfort level" adapts to higher volumes of sound, so what sounds "normal" can actually be loud and harmful to your hearing. Guard against this by setting your equipment at a safe level BEFORE your hearing adapts.

ESTABLISH A SAFE LEVEL:

- Set your volume control at a low setting.
- Slowly increase the sound until you can hear it comfortably and clearly, without distortion.
- Once you have established a comfortable sound level, set the dial and leave it there.

BE SURE TO OBSERVE THE FOLLOWING GUIDELINES:

- Do not turn up the volume so high that you can't hear what's around you.
- Use caution or temporarily discontinue use in potentially hazardous situations.
- Do not use headphones while operating a motorized vehicle; the use of headphones may create a traffic hazard and is illegal in many areas.

Safety Precautions

Always observe the precautions described here to prevent harm to yourself and others and to prevent damage to property before it happens.

Important safeguards

WARNING

- Do not install this product in your vehicle if its location or use would obstruct the driver's clear view of the road or the operation of any vehicle airbag. It is also the driver's responsibility to know and comply with the laws, rules, and regulations of the driving location, including, for example, passenger privacy rights, and not to use the device in any location where its installation or use is prohibited.
- Do not use this device to make audio or video recordings prohibited in the location where you are using this product. Always provide the notice that is required in your location that video and audio recordings (if audio is in use) are being made and obtain appropriate consent and authorization from the persons being recorded. Some states, provinces and municipalities require posting a visible written notice that occupants and conversations are being recorded.
- Any obstruction of or other interference with the airbag, either deployed or non-deployed, or with the clear view of the road must be avoided and, accordingly, professional installation is required.
- We recommend that this product be set up and installed by a technician who has special training and experience in mobile electronics.
- Do not locate this product between the front windshield and car sun shade. This may cause heat to build up, resulting in deformation or malfunction of this product. If you want to use the sun shade when using Parking Mode, cut out the Dash Camera part or so.

Important safety information

WARNING

- Do not allow this product to come into contact with liquids. Electrical shock could result. Also, damage to the product, smoke, and overheating could result from contact with liquids.
- This product is designed for vehicles of 12 VDC, negative earth. Do not use in 24 VDC vehicles. Use of this product in 24 VDC vehicles may result in fire or damage.
- If liquid or foreign matter should get inside this product, park your vehicle in a safe place, turn the ignition switch off (ACC OFF) and consult your dealer or the nearest authorized Pioneer Service Company. Do not use this product in this condition because doing so may result in a fire, electric shock, or other failure.
- If you notice smoke, a strange noise or odor from this product, or any other abnormal signs on the LCD screen, turn off the power immediately and consult your dealer or the nearest authorized Pioneer Service Company. Using this product in this condition may result in permanent damage to the system.
- Do not disassemble or modify this product, as there are high-voltage components inside which may cause an electric shock. Be sure to consult your dealer or the nearest authorized Pioneer Service Company for internal inspection, adjustments or repairs.

Before using this product, be sure to read and fully understand the following safety information:

- Do not operate this product if doing so will divert your attention in any way from the safe operation of your vehicle. Always observe safe driving rules and follow all existing traffic regulations. If you experience difficulty in operating this product or reading the display, park your vehicle in a safe location and apply the parking brake before making the necessary adjustments.
- Keep this manual handy as a reference for operating procedures and safety information.
- Certain functions (such as viewing of screen and certain button operations) offered by this product could be dangerous (possibly resulting in serious injury or death) and/or unlawful if used while driving.

Precautions before connecting the system

⚠ WARNING

- Firmly install this product so it does not fall off the windshield. If this product is not firmly installed, it may fall off the windshield while driving and cause an accident. Periodically inspect this product.
- Pioneer recommends that only authorized service company personnel, who have special training and experience in mobile electronics, set up and install this product.
- Secure all wiring with cable clamps or electrical tape. Do not allow any bare wiring to remain exposed.
- **It is extremely dangerous to allow cables to become wound around the steering column or shift lever. Be sure to install this product, its cables, and wiring away in such so that they will not obstruct or hinder driving.**
- **Make sure that the cables and wires will not interfere with or become caught in any of the vehicle's moving parts, especially the steering wheel, shift lever, parking brake, sliding seat tracks, doors, or any of the vehicle's controls.**
- Do not route wires where they will be exposed to high temperatures. If the insulation heats up, wires may become damaged, resulting in a short circuit or malfunction and permanent damage to the product.
- Do not shorten any cables. If you do, the protection circuit (fuse holder, fuse resistor or filter, etc.) may fail to work properly.
- Never feed power to other electronic products by cutting the insulation of the power supply cable of this product and tapping into the cable. The current capacity of the cable will be exceeded, causing overheating.

To prevent damage

⚠ WARNING

- When replacing the fuse, be sure to only use a fuse of the rating prescribed on this product.

Precautions before installation

⚠ WARNING

- **Do not install this product where it may**
 - obstruct the driver's vision,**
 - impair the performance of any of the vehicle's operating systems or safety features, including airbags, hazard lamp buttons or**
 - impair the driver's ability to safely operate the vehicle.**
- **Never install this product in front of or next to the place in the dashboard, door, or pillar from which one of your vehicle's airbags would deploy. Please refer to your vehicle's owner's manual for reference to the deployment area of the frontal airbags.**

⚠ CAUTION

- To ensure proper installation, be sure to use the supplied parts in the manner specified. If parts other than those supplied are used, they may damage internal parts of this product or come loose and the product may become detached, which could injure the driver or passengers if the vehicle stops suddenly.
- Before making a final installation of this product, temporarily connect the wiring to confirm that the connections are correct and the system works properly.
- Do not install this product in places subject to high temperatures or humidity, such as:
 - Places close to a heater, vent or air conditioner.
 - Places that may be exposed to rain, such as close to the door.

Disclaimer

- Given the large number of variables and conditions that can be involved in an accident, Pioneer cannot guarantee that every accident or occurrence will trigger the recording feature in this device.
- This product's features may not operate properly due to the effects of settings, how this product is installed, the condition of the microSD card, and driving conditions (including the road conditions).
- If brightly colored objects are placed on the dashboard, they may be reflected in the front windshield and the camera image. Do not place brightly colored objects on the dashboard.
- Video files from this product are not guaranteed to be admissible as evidence in the event of an accident.
- This product is not guaranteed to save video in all situations.
- You may not be able to recognize the conditions in the front of the vehicle in recorded video, depending on the ambient conditions, such as the weather and time of day.
- LED traffic signals or street lamps on the road may appear as flashing or flickering when recorded with this product. The color may also not be correctly identifiable. Pioneer accepts no responsibility whatsoever for these phenomena.
- This product is designed to save video before and after an accident occurs by detecting the impact (acceleration) with the G-sensor (accelerometer). However, this product is not guaranteed to save video in all situations.
- Pioneer accepts no responsibility whatsoever for product failures or damage that occur due to the microSD card wearing out.
- Pioneer does not make any assurances that microSD card problems will be repaired by formatting the card. Pioneer bears no responsibility for files that are erased from the microSD card or damage that occurs from formatting the card. Format the microSD card according to your own judgment and at your own responsibility.
- Always install this product in the specified installation position to ensure a safe field of view while driving and to achieve full performance from the product. Pioneer is not liable for any damages due to faulty or improper installation or use of the product.

How to read this Manual

Notation	Meaning
	These symbols are used to draw your attention to items you should be aware of when using this product and items you should be aware of to maintain its performance.
Note /Notes	Notes provide useful tips and extra information about product features.
[○○]	Square brackets are used to indicate selectable items displayed on the screen.
→ “○○○○”	Quotation marks are used to indicate references and settings.

- The illustrations and example screens used in this manual may differ from the actual product.
- In this manual, the microSDHC/SDXC memory card is referred to as “the microSD card” for convenience.

Usage Precautions

Precautions When Handling this product

- The driver may manually set the device to save video to assist in the monitoring of driver performance.
- There are limits to the scope of video that can be recorded with this product (→ **“Specifications”**). First check the video that will be recorded before using this product.
- Do not use it in high temperature above 60 °C (+140 °F) or low temperature below -10 °C (+14 °F) and high humidity.
- Be careful not to infringe on the privacy of any subject in recordings made with this product when using such recordings. You are fully responsible for the use of such recordings, which may include personal information, situations such as numbers on number plates.
- If the power supply to this product is stopped by turning off the vehicle engine when the holding capacitor is not sufficiently charged, situations such as immediately after purchase, the recording time may be shortened or recording may not be possible.
- For power supply, be sure to use the power cable that is provided with this product.
- Pioneer does not offer a data recovery service for corrupted or deleted files.
- The storage areas on the microSD card are split into the four areas shown in the following diagram according to the type of recording.

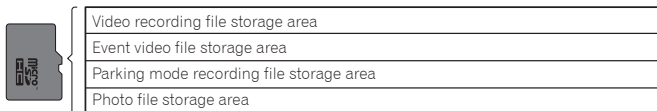

- Note that files will be overwritten when there is insufficient free space in the file storage areas. We recommend that you back up any important files you want to keep. → **“Backing Up Recorded Files”**
- To ensure that important files, such as files containing records of accidents, are not damaged or corrupted, always turn the power off before removing the microSD card and store the card in a safe place. → **“Inserting and Ejecting the microSD Card”**
- You can view video files on your PC. However, the video may stutter or stop depending on the performance of the PC.
- If this product is used near another device that uses GPS, such as a car navigation system, that device may temporarily be unable to receive radio waves from GPS satellites due to radio interference. There may also be a negative impact on the functions of surrounding devices.
- Do not touch the lens with your hands. Wipe the lens off with a soft cloth if you touch it.
- Do not replace the backup lithium rechargeable battery. If required, please contact the dealer or the nearest authorized Pioneer Service for replacement in the event of a malfunction, as data loss may occur.

Precautions When Handling the microSD Card

- Keep the microSD card out of the reach of small children to prevent them from accidentally swallowing it.
- To prevent data loss and damage to the microSD card, never remove it from this product while data is being transferred.
- If data loss or corruption occurs on the microSD card for any reason, it is usually not possible to recover the data. Pioneer accepts no liability for damages, costs or expenses arising from data loss or corruption.
- Never insert or eject a microSD card while driving.
- This product supports the following microSD cards.

	microSDHC	microSDXC
Capacity	8 GB to 32 GB	64 GB to 128 GB
File system	FAT32	
Speed class	Class 10 or better	

The microSD card is a consumable product.

Not all microSD cards are guaranteed to work with this product.

- Format the microSD card before using it. Do not use a microSD card that contains other data, such as that from a PC.
- Periodically format the microSD card after transferring any needed files, such as accidents, to other secure storage.
- Do not eject the microSD card when it is being accessed. The file or card may be corrupted.
- Even if the microSD card is used normally, you may no longer be able to write data to the card or erase data from the card normally.
- The service life of the microSD card is not covered under the warranty.
- The microSD card is a consumable part. We recommend that you regularly replace the microSD card with a new card. If you use the microSD card for a long period of time, this product may no longer be able to save data to the card correctly due to bad sectors, or an error may occur and the card will no longer be usable.
- On rare occasions, a microSD card that is recognized by your computer may not be recognized by this product. In this case, depending on the problem with the microSD card, this product may be able to recognize the card by formatting it with this product format feature → **“Product Settings” - “Configurable Features” - “Values” - “System” - “Format SD Card”**. However, all files, including protected files, saved to the microSD card will be erased when it is formatted. Always transfer files on the microSD card to other secure storage before formatting it.
- Pioneer does not make any assurances that microSD card problems will be repaired by formatting the card. Pioneer bears no responsibility for files that are erased from the microSD card or damage that occurs from formatting the card. Format the microSD card according to your own judgment and at your own responsibility.

Check the Accessories

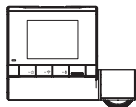

Main Unit×1



2nd Camera×1



Mounting Bracket×1



Power Cable
(5 m/16 ft. 5 in.)×1



2nd Camera
Connection Cable
(3 m/9 ft. 10 in.)×1*



2nd Camera
Connection Cable
(6 m/19 ft. 8 in.)×1*



microSDHC Card
(16 GB)×1



Quick Start Guide×1



Warranty×1



Cleaning Cloth×1

* The 2nd camera connection cable is included already connected.

Before Installing the Product

⚠ WARNING

- Never install on the cover of an airbag or at locations that might obstruct the deployment of the airbag. Doing so might prevent the airbag from being deployed normally, cause the product to fly out due to airbag deployment, and cause accident and injury.
- First check with the vehicle manufacturer for precautions related to the installation work when installing the product in a vehicle equipped with airbags. Otherwise there is a risk of airbag malfunction.

⚠ CAUTION

- Always use the included parts as specified. There is a risk of product failure if other parts are used.
- Install this product in a location where it will not hinder vehicle equipment and the ability to drive the vehicle.

Installation Precautions

- The main unit and 2nd camera are for installation to the inside of the front and rear windows only. Do not install it anywhere else inside or outside of the vehicle.
- When installing the main unit to the inside of the front windshield, be sure to install it to the specified positions of the front windshield and within the specified dimensions.
- When installing the 2nd camera to the inside of the rear window, pay attention to the following points.
 - Avoid installing the 2nd camera on heating wires.
 - If the vehicle is provided with a rear wiper, install so that it is within the wiping range of the wiper. (Rain and stains make it difficult to see the image)
 - Install the 2nd camera as far as possible from the high mount stop lamp.
- Depending on the vehicle, installation at the specified location and within the specified dimensions may not be possible. For details, consult with your dealer.
- Do not cover this product and 2nd camera or get the lens dirty.
- Do not place reflective objects near the lens.
- Take care when handling this product and 2nd camera so that they do not drop and you do not touch the lens.
- Recording quality may be affected if the front windshield of the vehicle is coated or has been specially treated.
- This product may not be able to receive GPS signals if the front windshield of the vehicle has been specially treated. Check the GPS reception status indicator displayed on the screen of this product. If a GPS signal cannot be received, this product cannot be installed in this vehicle. → **“Using this product” - “Status Display”**
- Choose a working location free from dust and debris in the air.
- When the temperature is low or there is condensation on the glass, turn on the heater and defroster to warm up the window in order to prevent poor adhesion of the double-sided tape.

Double-sided tape cannot be re-applied once it is peeled off as peeling off weakens its adhesive strength. Be sure to temporarily fasten this product and 2nd camera and sufficiently consider routing of cables before applying double-sided tape.

Before Installing and Securing the Product

First, temporarily connect this product and confirm that it operates correctly, and then install it. If the product does not operate correctly, check again if there is a mistake in the connection.

Before Applying Double-sided Tape

Clean the location where the double-sided tape will be applied.

WARNING

- Install firmly so that it does not come off. Incorrect installation may cause this to peel off while driving and cause an accident. Inspect the installation state from time to time.

Installation

Specified Installation Position on Front Windshield

When installing this product, install in a position that satisfies all of the following conditions if allowed by applicable law in your location:

- Install in a 7-inch/17.8 cm square in the lower corner of the windshield farthest from the driver, a 5-inch/12.7 cm square in the lower corner of the windshield nearest to the driver and outside of any airbag deployment zone, or in a 5-inch/12.7 cm square mounted to the center uppermost portion of the interior of the windshield. The ideal location is behind the rearview mirror out of the driver's view as shown below.
 - A position where this entire product is within 20 % of the top edge of the height of the front windshield (range within 20 % of the actual length, excluding parts overlapping weatherstrips, mouldings, etc. and masked parts) or is in the shadow of the rear view mirror as viewed from the driver's seat.
- Note that "20 %" as described above is a rough estimate. Please install the product in accordance with your location's laws and regulations.
- A position where the lens part of this product is within the wiping range of the wiper.
 - A position where the lens part of this product does not hang over the sunshade or the black ceramic lines/black ceramic pattern.
 - A position where this product faces in the horizontal direction to the front.
 - A position where the power cable can be routed without unnecessary force.

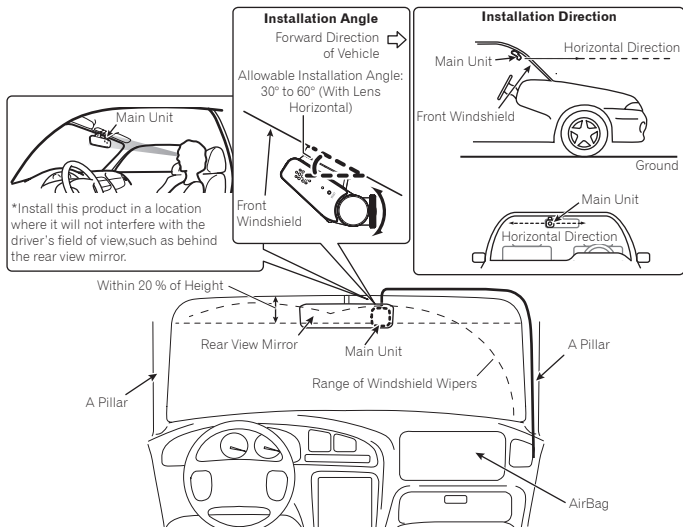

⚠ IMPORTANT

- Always install this product in the specified installation position to ensure a clear view of the road while driving and to achieve full performance from the product.
Pioneer is not liable for any damages due to faulty or improper installation or use of the product.
- For vehicles equipped with driver-assistance systems, there may be areas where the installation of accessory items is prohibited. For details, please refer to the instruction manual of your vehicle.
- Installing the Dash Camera main unit or cables near the film antenna element may affect the TV reception sensitivity.

Recommended Installation Position on Rear Windshield

When installing the 2nd camera on the inside of the rear window, installation in a vehicle and in a position that satisfies all of the following conditions is recommended.

- A position where the lens part of the 2nd camera is within the wiping range of the wiper.
- A position where the 2nd camera faces in the horizontal direction to the rear and side to side.
- A position where the lens part of the 2nd camera and the double-sided tape do not overlap the heating wires.
- A position where the 2nd camera connection cable can be routed without unnecessary force.

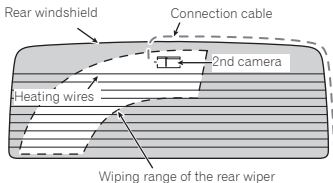
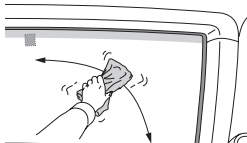
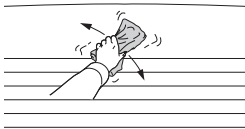
**1 Clean the installation area of dirt and oils using the included cleaning cloth.****Front windshield****Rear windshield****2 Install this product.**

- Set the mounting bracket on the main unit.
- Peel off the double-sided tape release paper from the mounting bracket.
- Install at the specified position of the front windshield.

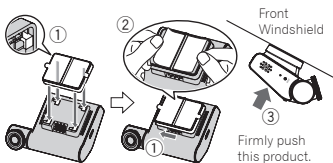

⚠ CAUTION

- Make sure that the surface of the front windshield is clean and dry before applying the tape.
- Firmly push the area around the LCD. Next, remove this product from the mounting bracket, and directly press the mounting bracket against the tape. In this way, the product can be firmly installed on the windshield.
- Never touch the surface of the LCD.
- Use extreme care as the double-sided tape on the mounting bracket is extremely strong, and should not be reapplied once it has been applied.
- To ensure the installation strength of the adhesive tape, leave this product for 24 hours after application before using it.

3 Install the 2nd camera.

- ① : Peel off the double-sided tape release paper from the 2nd camera.
- ② : Install in the specified position on the rear window so the image of the 2nd camera is displayed horizontally with the flat part shown in the figure (the \triangle on the side faces up) facing upwards.

Note

- You can use the dedicated app to display the 2nd camera's image horizontally to support installation. → **"Dedicated App"**

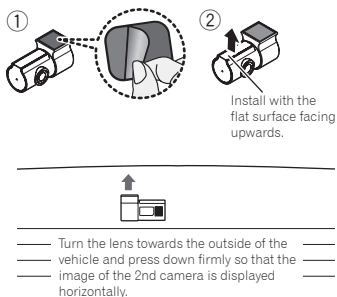

⚠ CAUTION

- If the image of the 2nd camera is not displayed horizontally, it may not detect approaching vehicles behind correctly.

4 Connect the Dash Camera main unit, power cable, and 2nd camera connection cable.

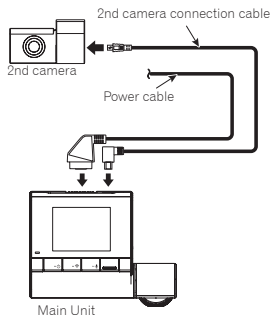

5 Route the power cable and 2nd camera connection cable along the passenger side.

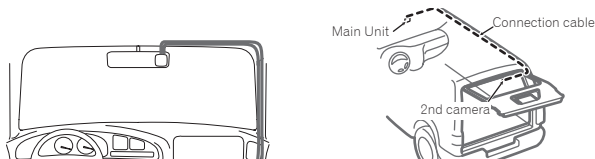

6 Connect the power cable.

→ *“Connecting the Power Cable”*

7 Turn the vehicle engine on to display the recording screen.

8 Adjust the angle of the lens so that video outside and inside the vehicle is properly displayed.

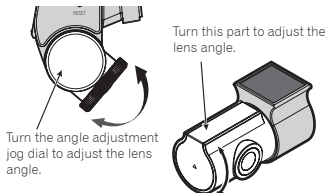

Before driving, turn the lens of this product towards the outside of the vehicle.

This product restarts when the lens angle is moved from the outside of the vehicle to the inside, and vice versa.

To switch between camera video from this product and video from the 2nd camera, press the  button. → **“Function Buttons”**

Note

- A protective film is applied to the lens when the product is purchased. Peel off this film.

Connecting the Power Cable

- Be sure to disconnect the \ominus terminal of the vehicle's battery before connecting the power cable.
- The product should be installed by authorized service company personnel who have special training and experience with mobile electronics products.

By using the power cable to draw power directly from the vehicle, this product can detect and record vehicle movement caused by vibration even when the vehicle's engine is turned off.

→ **"Product Settings"** - **"Configurable Features"** - **"Values"** - **"Parking Mode"** - **"Security Mode"**

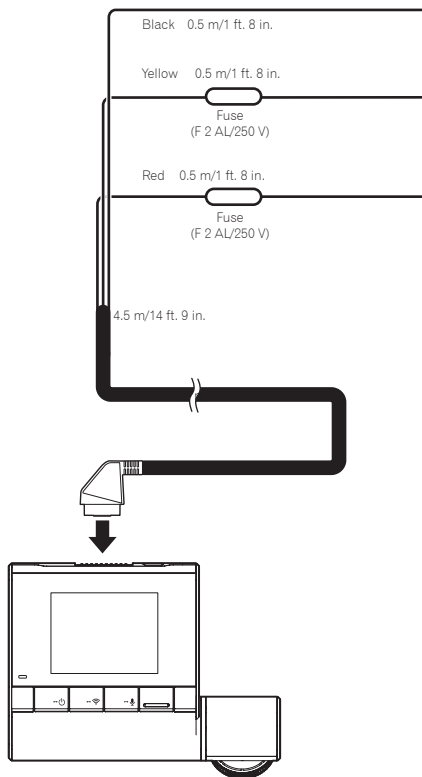

Ground (Black)

Securely connect to the metal part of the vehicle body. To prevent noise, connect as close to the navigation unit as possible.

+ Battery power supply (Yellow)

Always connect to the power circuit supplied with power from the battery, regardless of whether the vehicle engine switch is ON or OFF.

Accessory power supply (Red)

Connect to the power circuit supplied with power when the vehicle engine switch is turned to the ACC position.

Never install the accessory power supply to a vehicle that does not have an ACC position on the engine switch. Doing so may lead to a dead battery.

Note:

Connect the red and yellow lead wires to the terminals after wiring through the vehicle's fuse unit.

⚠ Connection Precautions

- To prevent fuming and damage to the product, be sure to first securely connect the black lead wire (Ground) of this product to the metal part of the vehicle body. Connect separate black lead wires (Ground) for products with a high current consumption such as a power amplifier. When setting up connections all at once, there is a risk of fuming or damage to the product when screws loosen or come off completely.

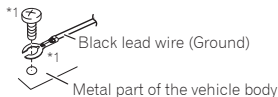

***1 Not supplied for this unit**

Part Names

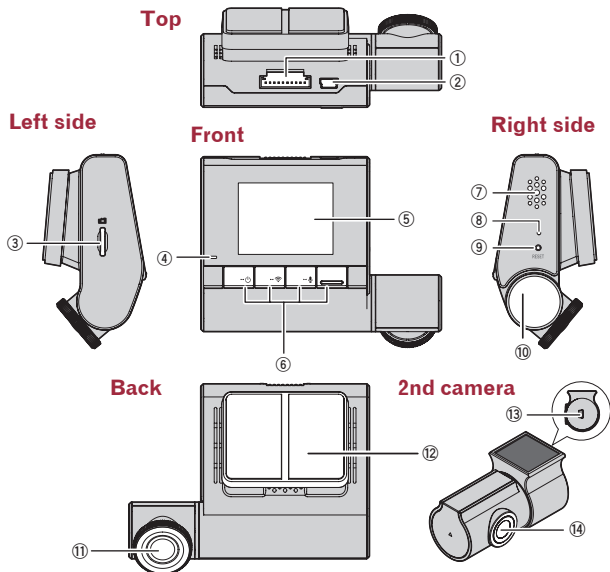

① Power Port

Connect the power cable.

② 2nd Camera Connection Terminal

Connect to the 2nd camera connection terminal (13) using the 2nd camera connection cable.

③ microSD Card Slot

④ System Indicator

⑤ LCD

⑥ Function Buttons

⑦ Speaker

⑧ Microphone

⑨ Reset Button

Press this button with the tip of a ballpoint pen to reset this product.

⑩ Angle Adjustment Jog Dial

The angle of the lens can be adjusted by turning this dial.

⑪ Lens

⑫ Mounting Bracket

⑬ Connection Terminal

⑭ Lens

Inserting and Ejecting the microSD Card

Turn off the power to this product when inserting and removing the microSD card. → **“Manually Turning the Power On and Off”**

Inserting the microSD Card

Hold the top edge of the microSD card, position the microSD card so that the label is facing the backside of this product, and slowly insert it into the microSD card slot until it clicks.

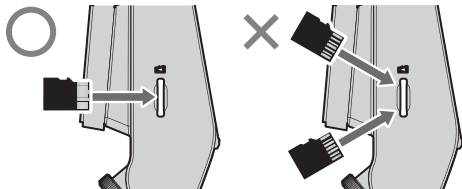

⚠ CAUTION

- Do not insert the microSD card at an angle. Doing so may cause damage.

Ejecting the microSD Card

Slowly push in the top edge of the microSD card until it clicks (①). The lock will be released. Pull out the microSD card (②).

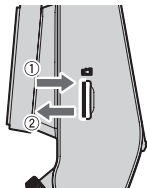

⚠ CAUTION

- Ensure care is taken when handling the microSD card, as it could become hot after being written.

Backing Up Recorded Files

When the free space of the file storage areas is low, files are deleted from the oldest file. We recommend that you back up any important files you want to keep with the following procedure.

Note

- Prepare a spare microSD card in advance.

1 Replace the microSD card.

Stop the vehicle in a safe location. Then turn off power operation, eject the microSD card, and replace it with a spare microSD card.

Note

- After microSD card replacement, perform a format before use.

2 Copy or move the files to a PC.

Insert the microSD card into a PC, using a commercially available SD card adapter if necessary. Copy or move the videos and photo files to back up to a suitable location on the PC.

Folder and File Structure

The structure of folders and files in a microSD card is as follows.

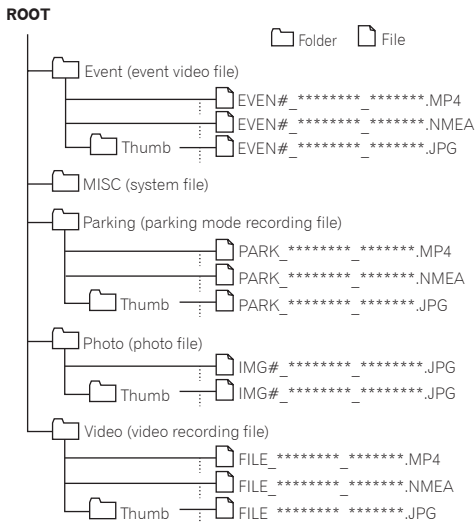

Notes

- A symbol that indicates this product camera "M" or 2nd camera "E" is automatically assigned at "#".
- The year, month, day, hours, minutes, and seconds are automatically assigned at "*****_*****".

Using this product

Before using this product, first stop the vehicle in a safe location and apply the parking brake.





Power Operation

This product starts when the vehicle's engine is turned on (ACC ON), and it automatically starts recording. (Video recording) → **"Using this product" - "Video Recording"**

If the camera of this product is facing the inside of the vehicle when the vehicle engine is turned on (ACC ON), a message is output and the alarm sounds.

Manually Turning the Power On and Off

This product can be manually turned on and off.

Hold down the  function button in the recording screen for at least three seconds. The power off confirmation screen is displayed. Press the  /  function button to select [Yes], and press  to turn the power off. Hold down the  function button again for at least three seconds, and the power is turned on.

System Indicator Display

The operating status of this product is displayed with the system indicator.

System Indicator	Menu Displayed/ During Playback	Video Recording	Recording Event	Under parking surveillance	Error Has Occurred (Including microSD Card not Inserted)
Illuminated green	—	○	—	○	—
Illuminated red	—	—	○	—	—
Blinking red	—	—	—	—	○

Function Buttons

The functions of the function buttons are indicated by the icons displayed at the bottom of the screen. The functions of the buttons will depend on the displayed screen. (Icons are not displayed on some screens.)

In the playback screen or MENU screen, pressing the  function button returns you to the previous screen.

Recording



- ① **Main menu display**
- ② **Switching of camera video**
Hold down to switch Wi-Fi on/off
- ③ **Take photos**
Hold down to switch microphone on/off
- ④ **Manual recording of event**

During playback



- ⑤ **Back**
- ⑥ **Previous file**
- ⑦ **Next file**
- ⑧ **Play/stop, delete**

During MENU screen display

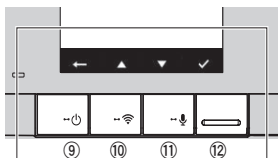

- ⑨ **Back**
- ⑩ **Up***
Hold down to switch Wi-Fi on/off
- ⑪ **Down***
Hold down to switch microphone on/off
- ⑫ **Confirm**

* When the volume or sensitivity MENU screen is displayed, increase or decrease the volume or sensitivity.

Status Display

The status display shows the operating status of this product.



- 1 Recording in progress
- 2 Elapsed recording time
- 3 Event recording status*1
- 4 Parking mode
- 5 Sound recording*2
- 6 Wi-Fi connection status*3
- 7 GPS reception status*4

*1 When manual event recording is performed, or vibration, sudden braking or an approaching vehicle behind is detected in the event recording mode, and event recording has been activated, "x2" is displayed.

*2 A red "\ " is displayed when sound recording is set to off.

*3 During a Wi-Fi connection, this is displayed in green, and when Wi-Fi is disconnected, this is displayed in white. A red "x" is displayed when Wi-Fi connection is set to off.

*4 During GPS reception, this is displayed in green, and when GPS cannot be received, this is displayed in white. In Parking Mode, a red "x" is displayed since GPS reception is set to off.

Video Recording

Recording automatically starts when this product is started. The recorded video is saved to the microSD card as one file of the set increment of time (default: 3 minutes), and when the microSD card runs out of free space, the files are overwritten starting from the oldest file.

Notes

- You can change the video recording time.
→ **"Product Settings" - "Configurable Features" - "Values" - "Video Recording" - "Video Clip Length"**
- Video recording will stop under the following circumstances.
 - When the MENU screen is displayed
 - When the power supply is stopped
 - When parking mode has started
- The recording time may differ depending on the conditions.

Automatic Recording by Detecting Impacts

When an impact is detected by this product, such as an impact with another vehicle, a file from the continuous video recording is automatically saved for the 20 seconds before and 20 seconds after the moment of detection as an event video file. → **“Event Video Timing and Save Location”**

Automatic Recording by Detection of Sudden Braking

When sudden braking is detected by this product, such as when the vehicle is cut off or when the vehicle in front brakes suddenly, a file from the continuous video recording is automatically saved for the 20 seconds before and 20 seconds after the moment of detection as an event video file. → **“Event Video Timing and Save Location”**

Automatic Recording by Detection of Approaching Vehicle Behind

When a vehicle traveling behind in the same lane maintains a close distance for a set period of time or if it approaches close behind while driving at or more than the set speed, this is automatically saved by the 2nd camera for 20 seconds before and after detection of the approaching vehicle as an event video file. → **“Event Video Timing and Save Location”**

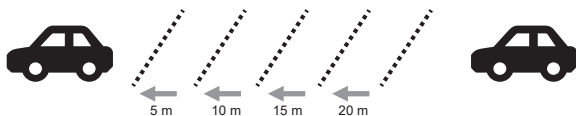

Detection Range

The device detects following vehicles in a straight line behind the 2nd camera.

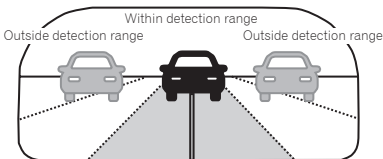

Event Video Timing and Save Location

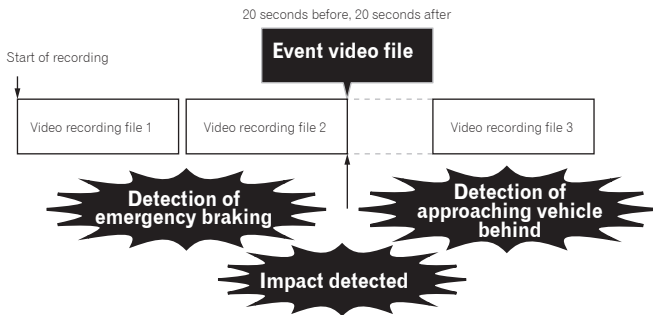

- * The video recording file is saved to the "Video" folder.
- * The event video file is saved to the "Event" folder.

Manual Recording (Manual Event Recording)

The manual recording file when the  function button is pressed during video recording is saved for the 20 seconds before and 20 seconds after the moment the button is pressed as an event video file.

Notes

- You can adjust the sensitivity for detecting impact, sudden braking, and approaching vehicle behind.
→ **"Product Settings" - "Configurable Features" - "Values" - "Video Recording" - "G-Sensor Sensitivity", "Sudden Brake Detection", "Tailgating Sensitivity"**
- If an impact, sudden braking, or approaching vehicle behind is detected during event recording, then after the event video recording ends, a new event video recording will start.
- The recording time may differ depending on the conditions.
- If an approaching vehicle behind is detected, a message will be displayed.
- After sudden braking has been detected, subsequent sudden braking will not be detected for approximately 2 seconds.
- To enable detection of an approaching vehicle behind, you need to adjust **"Calibration"** and set **"Mounting Height Setting"** for the 2nd camera images. → **"Product Settings" - "Configurable Features" - "Values" - "Video Recording" - "Calibration", "Mounting Height Setting"**
- In the following situations, accurate detection of an approaching vehicle behind may not be possible.
 - If **"Calibration"** is not adjusted correctly, or if the 2nd camera is mounted so that the horizon line is outside the adjustable range of **"Calibration"**
→ **"Product Settings" - "Configurable Features" - "Values" - "Video Recording" - "Calibration"**
 - If **"Mounting Height Setting"** is not set correctly
→ **"Product Settings" - "Configurable Features" - "Values" - "Video Recording" - "Mounting Height Setting"**
 - When the 2nd camera is unable to recognize the following vehicle correctly because of strong light or shade, dark areas, or strength of car headlights
 - When the 2nd camera is unable to recognize the following vehicle correctly because of weather conditions (rain, snow, fog, etc.) or the driving environment (rough road environment, etc.)
 - When GPS cannot be detected, such as in a tunnel
 - When the following vehicle is a motorcycle

Parking Mode

When the power supply to this product is turned off (vehicle engine is turned off), Parking Mode is activated for a fixed period of time. The maximum operation time is approximately 40 minutes. When this device detects vehicle movement caused by vibration while Parking Mode is activated, that event is saved for 20 seconds before and 20 seconds after the moment of detection as a parking mode file, and a notification message is displayed at the next startup.

Notes

- Parking Mode can be set to on or off. The operation time of Parking Mode can also be set.
→ **“Product Settings” - “Configurable Features” - “Values” - “Parking Mode” - “Video Clip Length”**
- You can adjust the sensitivity for detecting vibration.
→ **“Product Settings” - “Configurable Features” - “Values” - “Parking mode” - “G-Sensor Sensitivity”**
- Vibration that is detected for approximately three minutes after power supply to this device is stopped and for approximately three minutes before power supply is started is not covered by the notification message display feature.
- The recording time may differ depending on the conditions.

Security Mode

If the pre-set operation time elapses when Security Mode is turned ON, Security Mode, parking surveillance operates continuously, is automatically activated.

When this device detects vehicle movement caused by vibration while Security Mode is activated, that event is saved for one minute after the moment of detection as a parking monitoring file, and a notification message is displayed at the next startup.

Notes

- Security Mode can be set to on or off.
→ **“Product Settings” - “Configurable Features” - “Values” - “Parking Mode” - “Security Mode”**
- In Security Mode, this product runs in the low power consumption mode to reduce the risk of the battery going dead.
- Security Mode starts recording within three seconds of detection of impact.
- Vibration that is detected for approximately three minutes before the vehicle's engine is turned on (ACC ON) is not covered by the notification message display feature.
- Security Mode is a feature for starting up and activating this product after an impact is detected. For this reason, the battery might wear more quickly if this product is used in multi-story parking garages or the location subjected to lots of vibration. When parking in locations such as these, set Security Mode to off before using this product.
- The recording time may differ depending on the conditions.
- In Security Mode, if the battery voltage approaches the set monitoring voltage, the recording time may be shortened to less than one minute to protect the battery.

About the Voltage Monitoring Function

When using Parking Mode, first configure the **“Voltage Monitoring”** settings. This function automatically prevents the battery from becoming depleted when the vehicle's battery voltage falls below a set voltage value.

→ **“Product Settings” - “Configurable Features” - “Values” - “Parking Mode” - “Voltage Monitoring”**

When the “Video Clip Length” setting is other than OFF, and the “Security Mode” setting is ON

When the voltage drops to the voltage value set in “Voltage Monitoring” +0.1 V or lower, this stops Parking Mode, and instead activates Security Mode.

When the voltage drops below the voltage value set in “Voltage Monitoring” during Security Mode, the device operation is stopped (power is turned off).

When the “Video Clip Length” setting is other than OFF, and the “Security Mode” setting is OFF

When the voltage drops to the set voltage value +0.1 V or lower, Security Mode is not activated and the device operation is stopped (power is turned off).

Notes

- Using a commercially available tester, measure the vehicle's battery voltage while the engine is off, and select a value that is the same or slightly lower than the measured voltage.
- The battery may already be low, and the voltage may have dropped. Additionally, voltage measurement may give a higher reading immediately after turning off the engine. Please note that the measured value may not be the actual value.
- If a tester is not available, please consult with a car dealer or specialist.
- The voltage detection may vary depending on the operating environment and vehicle conditions.

SD Card Life Detection Function

When a microSD card is installed, the buzzer of this product will beep and a message recommending the replacement of microSD card will be displayed on the screen when it has reached a set number of guaranteed writes.

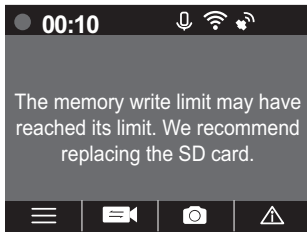

This message will be displayed at regular intervals until the microSD card is replaced. → **“Inserting and Ejecting the microSD Card”**

SD Card Format Warning Function

When a microSD card error is detected, the buzzer of this product will beep and a message recommending formatting the microSD card will be displayed on the screen.

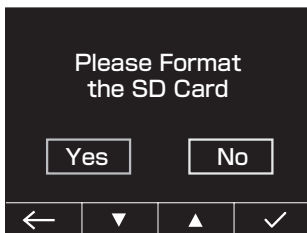

Press the / function buttons, then select [Yes] or [No], and press .

Yes:

A screen to reconfirm whether you want to format will be displayed.

Formatting will start if you select [Yes].

If you select [No], a screen will be displayed prompting you to restart. Select [Yes] and restart.

No:

A screen will be displayed prompting you to restart. Select [Yes] and restart.

Photography Feature

Photos can be taken during video recording or event recording by pressing the function button.

Playing Recorded Files

You can play recorded video files and view photo files.

1 Press the function button to open the main menu.

In each of the screens displayed from here on, the screen automatically returns to the recording screen if you do not perform any operation for approximately 30 seconds.

2 Press the / function buttons to select [File], and press .

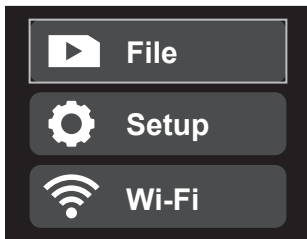

3 Press the  /  function buttons, select the folder, and then press .

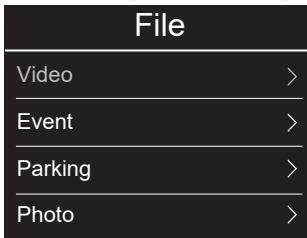

The thumbnails of files in the selected folder will be displayed.

4 Press the  /  function buttons, select the file, and then press .

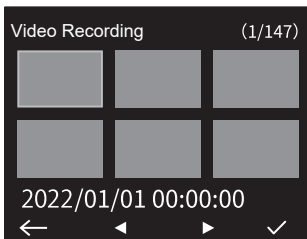

The selected file will play.

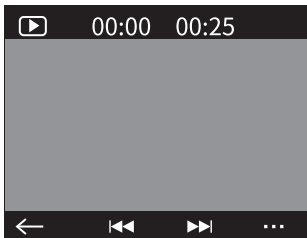

Note

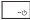
- In the screens in Steps 2 to 4 (excluding the playback screen), pressing the  function button returns you to the previous screen.

Product Settings

Before using this product, first stop the vehicle in a safe location and apply the parking brake.

These settings configure this product. You can reset the settings to the default settings. You can also format the microSD card and check this product version information.

Note that video recording will stop while the MENU screen is displayed.



1 Press the  function button to open the main menu.

In each of the screens displayed from here on, the screen automatically returns to the recording screen if you do not perform any operation for approximately 30 seconds.

2 Press the  /  function buttons, then select [Setup] or [Wi-Fi], and press .

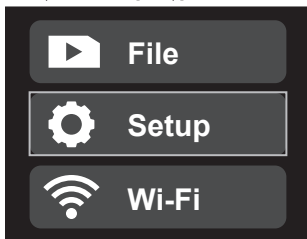
The following describes an example for when [Setup] has been selected.

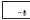

3 Press the  /  function buttons, select the setting category, and then press .

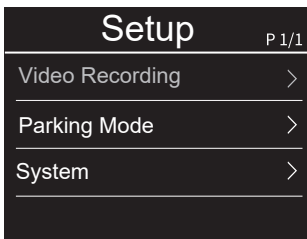

4 Press the  /  function buttons, select the setting item, and then press .

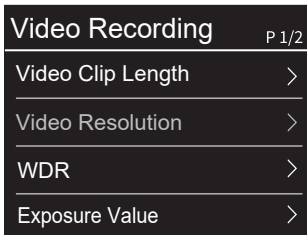

5 Press the  /  function buttons, select the setting value, and then press .

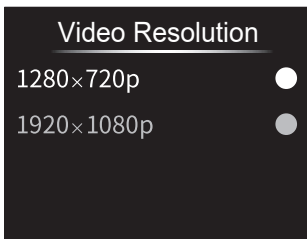

▼

This completes setting, and you are returned to the previous screen.

Note

- In the screens in Steps 2 to 4, pressing the  function button returns you to the previous screen.

Configurable Features

Values

Bold: The factory default setting.

Setting Category	Setting	Details	Set value
Video Recording	Video Clip Length	Sets the recording time for one video recording video file in video recording.	[1 min]/ [3 min] / [5 min]
	Video Resolution	Sets the image quality of video recording.*1	[1280 x 720p]/ [1920 x 1080p]
	WDR (Wide Dynamic Range)	Sets use of the feature that automatically adjusts the image in situations where there is a large difference between light and dark.*1	[ON] /[OFF]
	Exposure Value	Sets the exposure of video recording.*1	[-1.0]/[-0.7]/ [-0.3]/ [0] /[+0.3]/ [+0.7]/[+1.0]
	G-Sensor Sensitivity	Sets the sensitivity for detecting vibration or impact. If you set a high value, the sensitivity will increase.	[1] to [6] [4]
	Sudden Brake Detection	Sets the sensitivity for detecting sudden braking.	[High] /[Low]/ [OFF]
	Calibration	Sets the adjustment of the shooting range evenly up/down/left/right for the 2nd camera images.*2 → <i>“Correcting the Errors in the Shooting Range for Detection of an Approaching Vehicle Behind”</i>	Center
	Unit of measurement	Toggles [cm] and [inch] unit settings.	[cm]/ [inch]
	Mounting Height Setting	Sets the height from the ground to the lens on the 2nd camera.*2	[cm]: [50 cm] to [200 cm] [150 cm] [inch]: [20.0 inch] to [78.5 inch] [60.0 inch]
	Tailgating Sensitivity	Sets the sensitivity of detection of approaching vehicles behind.	[High]/ [Low] / [OFF]

*1 This setting is only available for the main camera. It is not available for the 2nd camera.

*2 Set this properly for correct detection of an approaching vehicle behind.

Setting Category	Setting	Details	Set value
Parking Mode	Video Clip Length	Sets the operation time of Parking Mode. This can also be set to OFF.→ "Parking Mode"	[10 min]/[30 min]/ [40 min]/[OFF]
	G-Sensor Sensitivity	Sets the sensitivity for detecting vibration or impact.	[1] to [6] [4]
	LED Indicator	Sets whether or not to light the LED indicator when Parking Mode is activated.	[ON]/[OFF]
	Security Mode	Sets whether or not to use Security Mode. → "Using this product" - "Parking Mode" - "Security Mode"	[ON]/[OFF]
	Voltage Monitoring	Sets to automatically stop the device operation (turn off the power) when the vehicle's battery voltage falls below a set voltage value.	[11.6V]/ [11.8V] / [12.0V]/[12.2V]
System	Link GPS Date/Time	Sets the time zone.*1	[GMT-12:00] to [GMT+12:00] [-05:00]
	Date/Time	Sets the time manually.	—
	Speed Unit	Sets the units used for speed display.	[MPH]/[km/h]
	System Sound Volume	Sets beeps and playback volume. This can also be set to OFF.	[OFF]/[1] to [5] [3]
	Mic Mute	Sets whether or not to record sound around this product during video recording.	[ON]/[OFF]
	SD Card Partition	Changes the SD card partition.	[74% 15% 10% 1%]/ [54% 15% 30% 1%]
	Button Sound	Sets whether or not to sound beeps.	[ON]/[OFF]
	Screen Setting*2	Sets the time that the product enters sleep mode. When the settings menu is displayed, the product does not enter sleep mode regardless of how this item is set.	[Always On]/ [Screen off in 10 secs.] [Screen off in 1 min.]/ [Screen off in 3 min.]
	Language	Sets the language used to display on screen.	[English]/ [Français]/ [Español]
	Format SD Card	All files on the microSD card are deleted. *3	—
	Restore to Default Settings	Settings are reset to the default settings.	—
Version	Allows you to check the version information of this product's firmware.	—	

*1 If this setting is changed, the change will apply at the moment after the vehicle engine is turned off (ACC OFF) and then on again (ACC ON).

*2 When Parking Mode or Security Mode is activated, LCD Standby turns off after ten seconds regardless of this setting.

*3 When there is some problem with the microSD card, a warning tone sounds and an alarm message, such as "No SD card" is displayed, and recording stops.

Wi-Fi

Setting Category	Setting	Details	Default Settings
—	—	Sets whether or not to connect a Wi-Fi tethering supported terminal to this product.	ON (connectible)

In the recording screen, Wi-Fi on/off can be switched by holding down the  function button.

Correcting the Errors in the Shooting Range for Detection of an Approaching Vehicle Behind

Sets adjustment of the shooting range evenly up/down/left/right. (Calibration)

1 Press the function button to open the main menu.

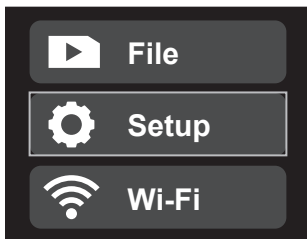

In each of the screens displayed from here on, the screen automatically returns to the recording screen if you do not perform any operation for approximately 30 seconds.

2 Press the / function buttons, then select [Setup], and press .

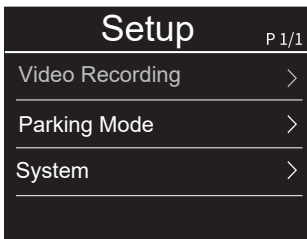

3 Press the / function buttons, then select [Video Recording], and press .



4 Press the  /  function buttons, then select [Calibration], and press .

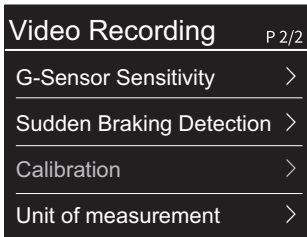

5 Press the  /  function buttons, then align with the horizontal line, and press .

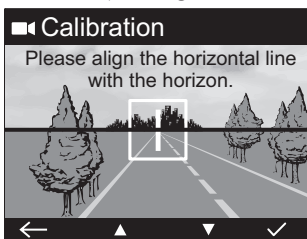

6 Press the  /  function buttons, then align with the center of the lane, and press .

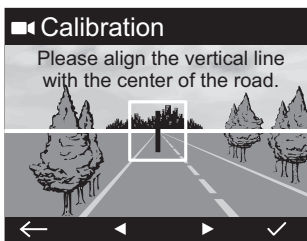

This completes setting, and you are returned to the previous screen.

Notes

- It is recommend you use the dedicated app to adjust and set correcting errors (calibration) in the shooting range of the 2nd camera. → **“Dedicated App”**
- If calibration is not performed properly, the function to detect an approaching vehicle behind may not operate correctly.

Guide to Recording Time and No. of Photos

The following table provides estimates of the video recording times and number of photos possible with different "SD Card Partition" settings. The actual values will depend on various factors, such as the microSD card being used, subject being recorded, and recording conditions.

The "SD Card Partition" setting is expressed as follows.

Example: [74% 15% 10% 1%]

As a percentage of memory card capacity, the video recording time will be 74 %, the event recording time will be 15 %, Parking Mode time will be 10 %, and the number of photos will be 1 %.

CAUTION

- If you change the "SD Card Partition" setting, the files recorded to the microSD card will be deleted. Before changing the "SD Card Partition" setting, be sure to create a backup of the microSD card files.

Guide to Recording Time and No. of Photos with an 16 GB microSD Card

SD Card Partition	Resolution	Video Recording	Event Recording	Parking Mode Recording	No. of Photos
[54% 15% 30% 1%]	1080p	Approx. 38 minutes	Approx. 10 minutes	Approx. 21 minutes	Approx. 400 photos
	720p	Approx. 44 minutes	Approx. 12 minutes	Approx. 24 minutes	Approx. 400 photos
[74% 15% 10% 1%]	1080p	Approx. 52 minutes	Approx. 10 minutes	Approx. 7 minutes	Approx. 400 photos
	720p	Approx. 1 hour	Approx. 12 minutes	Approx. 8 minutes	Approx. 400 photos

Guide to Recording Time and No. of Photos with an 128 GB microSD Card

SD Card Partition	Resolution	Video Recording	Event Recording	Parking Mode Recording	No. of Photos
[54% 15% 30% 1%]	1080p	Approx. 5 hours 9 minutes	Approx. 1 hour 26 minutes	Approx. 2 hours 52 minutes	Approx. 400 photos
	720p	Approx. 5 hours 58 minutes	Approx. 1 hour 39 minutes	Approx. 3 hours 18 minutes	Approx. 400 photos
[74% 15% 10% 1%]	1080p	Approx. 7 hours 4 minutes	Approx. 1 hour 26 minutes	Approx. 57 minutes	Approx. 400 photos
	720p	Approx. 8 hours 10 minutes	Approx. 1 hour 39 minutes	Approx. 1 hour 6 minutes	Approx. 400 photos

Dedicated App

The dedicated app "Dash Camera Interface" can be used to check the video recorded on this product or make settings on the screen of an iPhone or Android device.

- To use this app, a Wi-Fi connection must be made between this product and iPhone or Android device beforehand.
 - ① Set the Wi-Fi function of this product to on. → **"Product Settings"**
 - ② Start the dedicated app from your device.
 - ③ Operate the device to select this product as the Wi-Fi connection device.

The SSID name (access point name) and password of this product can be confirmed and changed on the Wi-Fi setting screen. We recommend that you change the SSID name and password from the default values. However, the SSID name and password will be returned to the default values if you reset the product to the factory default state.
- Only one device can be connected to this product at one time. When a second device is connected, the first device will be disconnected.
- While a Wi-Fi connection is made, no operations can be performed on this product. If a function button is pressed while a Wi-Fi connection is made, a message will be displayed prompting you to break the Wi-Fi connection. If you select [Yes], the Wi-Fi connection will be disconnected, and operations on this product will be enabled.
- It is recommended to enter the search term "Dash Camera Interface" in the search field to search for the application.



- For how to use the app, check  → [How to use] in the menu at the bottom of the screen of the dedicated app "Dash Camera Interface".

Trademarks & Copyrights

- microSDHC Logo is a trademark of SD-3C, LLC.



- microSDXC Logo is a trademark of SD-3C, LLC.



- Android is a trademark of Google LLC.
- The Wi-Fi CERTIFIED™ Logo is a certification mark of the Wi-Fi Alliance®.



- iPhone is a trademark of Apple Inc., registered in the U.S. and other countries.

GPS

- GPS (Global Positioning System) is a system that measures your current position by receiving position measurement radio signals from GPS satellites.
- The GPS satellite signals cannot pass through solid matter (except glass). The signals from GPS satellites may be blocked when this product is in the following locations.
 - Inside tunnels and parking structures
 - On the bottom level of a two-level highway
 - Around concentrations of skyscrapers
 - In dense forests

Troubleshooting

Check the following information before sending the product in for repairs.

Symptom	Cause	Action
An error occurred during the display and operation of this product.	The microcomputer in this product is malfunctioning.	Press the reset button. → “Part Names”
	There may be issues with the microSD card.	Format the microSD card. → “Product Settings” - “Configurable Features” - “Values” - “System” - “Format SD Card”
A file that should have been saved cannot be found.	If there is insufficient space in the storage areas of the microSD card, the files will be overwritten in order from the oldest files.	We recommend that you back up any important files you want to keep. → “Backing Up Recorded Files”
The product makes parking mode files when you get in and out of the vehicle.	The vibration when people get in and out of the vehicle and the movement of people are being detected.	Adjust the sensitivity of the sensors to use for detection. → “Product Settings” - “Configurable Features” - “Values” - “Parking Mode” - “G-Sensor Sensitivity”
There are many videos where nothing happens in the files recorded while parked.	The sensitivity of impact detection may not be appropriate.	
My vehicle was hit while parked, but a video file wasn't recorded.		
An accident occurred during driving, but a video file wasn't saved.	The sensitivity of impact detection may not be appropriate.	Adjust the sensitivity of the sensors to use for detection. → “Product Settings” - “Configurable Features” - “Values” - “Video Recording” - “G-Sensor Sensitivity”
There's no sound when I play a video file.	The sound recording setting may be OFF.	Check the sound recording setting again. → “Product Settings” - “Configurable Features” - “Values” - “System” - “Mic Mute”

Specifications

SD Memory Card Types/ Speed Class Rating	microSDHC/microSDXC card, Class 10 (8 GB to 128 GB)
Imaging Element	Approx. 2 million pixels (on-board high-sensitivity CMOS sensor)
Recording Angles	Main Unit: 130° horizontal, 68° vertical, 160° diagonal 2nd camera: 112° horizontal, 58° vertical, 137° diagonal
Focal Ratio Number	Main Unit: F2.0 2nd camera: F1.9
Resolution	1920 × 1080P/1280 × 720P
Image correction technology	WDR function (Main Unit – WDR ON/OFF, 2nd camera – HDR ON)
GPS	Built-in
Wi-Fi	<ul style="list-style-type: none">• On-board (for connection of iOS/Android dedicated apps) 802.11b/g/n• Output power: + 17.5 dBm Max.• Frequency band(s): 2412 MHz to 2462 MHz
G-Sensor	3-axis G-sensor (During event recording: level can be set in 6 steps/during parking mode: level can be set in 6 steps)
Recording Methods	Video recording/event recording/manual event recording/parking mode recording
Video File Structure	1 min/3 min/5 min
Display	2-inch LCD
Sound Recording	Can be set to ON or OFF
Frame Rate	27.5 fps
Compression Method	Video: MP4 (H.264), photo: JPG
Video Playback Method	iOS/Android dedicated apps, etc.
Power Supply Voltage	12 VDC (exclusive power supply included)
Power Consumption	Approx. 5 W
Operating Temperature	-10°C to +60°C (+14 °F to +140 °F)
Dimensions (W × H × D)	Main Unit: 106.1 mm × 78 mm × 46.7 mm (4-1/8 in. × 3-1/8 in. × 1-7/8 in.) (width × height × depth) 2nd camera: 63.2 mm × 37.1 mm × 31.6 mm (2-1/2 in. × 1-1/2 in. × 1-1/4 in.) (width × height × depth)
Weight	Main Unit: 145 g (0.3 lbs) (excluding bracket, etc.) 2nd camera: 35 g (0.08 lbs)
Allowable Installation Angle	30° to 60°

Register your product at

<https://www.pioneerelectronics.com>

in Canada

<https://www.pioneerelectronics.ca>

PIONEER CORPORATION

28-8, Honkomagome 2-Chome,
Bunkyo-ku, Tokyo 113-0021
Japan

PIONEER ELECTRONICS (USA) INC.

P.O. Box 1540, Long Beach, CA 90801-1540, U.S.A.
TEL: (800) 421-1404